

# CONTINENTAL GLASS SYSTEMS, LLC. SERIES 3900 WINDOW WALL W/WO REINFORCEMENT SMALL MISSILE IMPACT (SMI)

**GENERAL NOTES:**

- THIS PRODUCT HAS BEEN DESIGNED AND TESTED TO COMPLY WITH THE REQUIREMENTS OF THE 5TH EDITION FLORIDA BUILDING CODE (2014) INCLUDING HIGH VELOCITY HURRICANE ZONE (HVHZ).
- WINDOWS RATED FOR SMALL MISSILE IMPACT. IMPACT SHUTTERS ARE NOT REQUIRED FOR ELEVATIONS ABOVE 30'-0" FROM GRADE. IMPACT SHUTTERS ARE REQUIRED FOR ELEVATIONS BELOW 30'-0" FROM GRADE.
- THESE WINDOWS ARE APPROVED FOR AIR AND WATER INFILTRATION.
- ANCHORS SHALL BE AS LISTED, SPACED AS SHOWN ON DETAILS. ANCHORS EMBEDMENT TO BASE MATERIAL SHALL BE BEYOND WALL DRESSING OR STUCCO.
- ANCHORING OR LOADING CONDITIONS NOT SHOWN IN THESE DETAILS ARE NOT PART OF THIS APPROVAL.
- MATERIALS INCLUDING BUT NOT LIMITED TO STEEL/METAL SCREWS THAT COME INTO CONTACT WITH OTHER DISSIMILAR MATERIALS SHALL MEET THE REQUIREMENTS OF THE 5TH EDITION FLORIDA BUILDING CODE (2014) SECTION AS APPLICABLE.
- METAL STRUCTURES NOT BY CONTINENTAL GLASS SYSTEMS, LLC. DESIGNED TO SUPPORT THE LOADS IMPOSED BY THIS GLAZING SYSTEM AND TO TRANSFER SUCH LOADS TO THE BUILDING MAIN STRUCTURE.
- ULTIMATE LOAD OBTAINED FROM ASCE 7-10, MULTIPLY BY 0.6 SHALL BE LESS THAN OR EQUAL TO MAX. DESIGN LOAD IN THIS DOCUMENT. THE DESIGN LOADS SHOWN IN THIS DOCUMENT ARE ALLOWABLE DESIGN LOADS.

**SEALANTS:**

ALL FRAME CORNERS, JOINTS, MULLION SEAMS AND PERIMETER GLAZING BEAD TO FRAME INSTALLATION FASTENERS SEALED WITH SILICONE SEALANT.

FRAME PERIMETER SEALANT TO BE DOW CORNING DC790.

**-TYPICAL ANCHORS: (SEE ELEVATIONS FOR SPACING)**

TYPE 'A' -- 5/16" DIA. ULTRACON BY 'ELCO' (Fu 177 KSI, Fy=155 KSI) DIRECTLY INTO CONCRETE OR MASONRY 1-3/4" MIN. EMBED INTO CONCRETE.

TYPE 'B' -- 5/16" DIA. SELF DRILLING SCREWS (GRADE 5 CRS) INTO MIAMI-DADE COUNTY APPROVED MULLIONS (1/8" THK. MIN.) INTO METAL STRUCTURES  
STEEL: 1/8" THK. MIN. (6063-T5 MIN.)  
ALUMINUM: 1/8" THK. MIN. (6063-T5 MIN.)  
(STEEL IN CONTACT WITH ALUMINUM TO BE PLATED OR PAINTED)

TYPE 'C' -- #14 SMS OR SELF DRILLING SCREWS (GRADE 5 CRS) INTO MIAMI-DADE COUNTY APPROVED MULLIONS (1/8" THK. MIN.) INTO METAL STRUCTURE.

**TYPICAL EDGE DISTANCE**

INTO CONCRETE = 2-1/2" MIN.  
INTO METAL STRUCTURE = 3/4" MIN.

**INSTRUCTIONS:**

USE CHARTS AS FOLLOWS.

**STEP 1:** DETERMINE ALLOWABLE DESIGN LOAD REQUIREMENTS BASED ON WIND VELOCITY, BLDG. HEIGHT, WIND ZONE USING APPLICABLE ASCE 7-10 STANDARD.

**STEP 2:** SEE CHARTS ON SHEET G1 FOR DESIGN LOAD CAPACITY OF DESIRED GLASS SIZE. THE GLASS CAPACITY SHOULD BE GREATER THAN OR EQUAL TO THE ALLOWABLE DESIGN LOAD DETERMINED BY STEP 1.

**STEP 3:** CHECK MULLION AND JAMB CAPACITY FOR A GIVEN SPACING AND HEIGHT USING CHARTS ON SHEETS M1 & M2. THE CAPACITY SHOULD EXCEED THE DESIGN LOAD.

**STEP 4:** USING CHART ON SHEET A1 SELECT ANCHOR OPTION WITH DESIGN RATING MORE THAN DESIGN LOAD SPECIFIED IN STEP 1 ABOVE.

**STEP 5:** THE LOWEST VALUE RESULTING FROM STEPS 2, 3 AND 4 SHALL APPLY TO ENTIRE SYSTEM.

**LIMITATIONS OF USE**

A- THIS PRODUCT EVALUATION DOCUMENT (P.E.D.) PREPARED BY THIS ENGINEER IS GENERIC AND DOES NOT PROVIDE INFORMATION FOR A SITE SPECIFIC PROJECT; I.e. WHERE THE SITE CONDITIONS DEVIATE FROM THE P.E.D.

B- CONTRACTOR TO BE RESPONSIBLE FOR THE SELECTION, PURCHASE AND INSTALLATION OF THIS PRODUCT BASED ON THIS PRODUCT EVALUATION PROVIDED HE/SHE DOES NOT DEVIATE FROM THE CONDITIONS DETAILED ON THIS DOCUMENT.

C- THIS PRODUCT EVALUATION DOCUMENT WILL BE CONSIDERED INVALID IF ALTERED BY ANY MEANS.

D- SITE SPECIFIC PROJECTS SHALL BE PREPARED BY A FLORIDA REGISTERED ENGINEER OR ARCHITECT WHICH WILL BECOME THE ENGINEER OF RECORD (E.O.R.) FOR THE PROJECT AND WHO WILL BE RESPONSIBLE FOR THE PROPER USE OF THE P.E.D.

E- THIS P.E.D. SHALL BEAR THE DATE AND ORIGINAL SEAL AND SIGNATURE OF THE PROFESSIONAL ENGINEER OF RECORD THAT PREPARED IT.

SERIES 3900WW

FL #18312.2

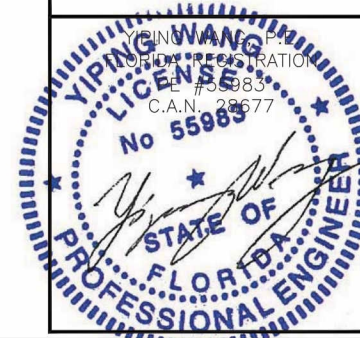

NO	DATE	REVISIONS DESCRIPTION

**MCY ENGINEERING, INC.**  
GLAZING CONSULTANTS

8501 SW 124 Ave, Ste. 205A  
MIAMI, FL 33183  
P: 305.271.0117  
F: 305.279.6818  
www.MCYEngineering.com    MCY.Engineering@Att.net

SERIES 3900 WINDOW WALL - SMI

**CONTINENTAL GLASS SYSTEMS, LLC.**  
325 WEST 74 PLACE HIALEAH, FL 33014  
TEL (305) 231-1101 FAX (305) 231-1103

**COVER**

DATE	08/21/15
SCALE	AS SHOWN
DRAWN	T.G.
PROJECT	15-101

DRAWING NO.  
AD15-58

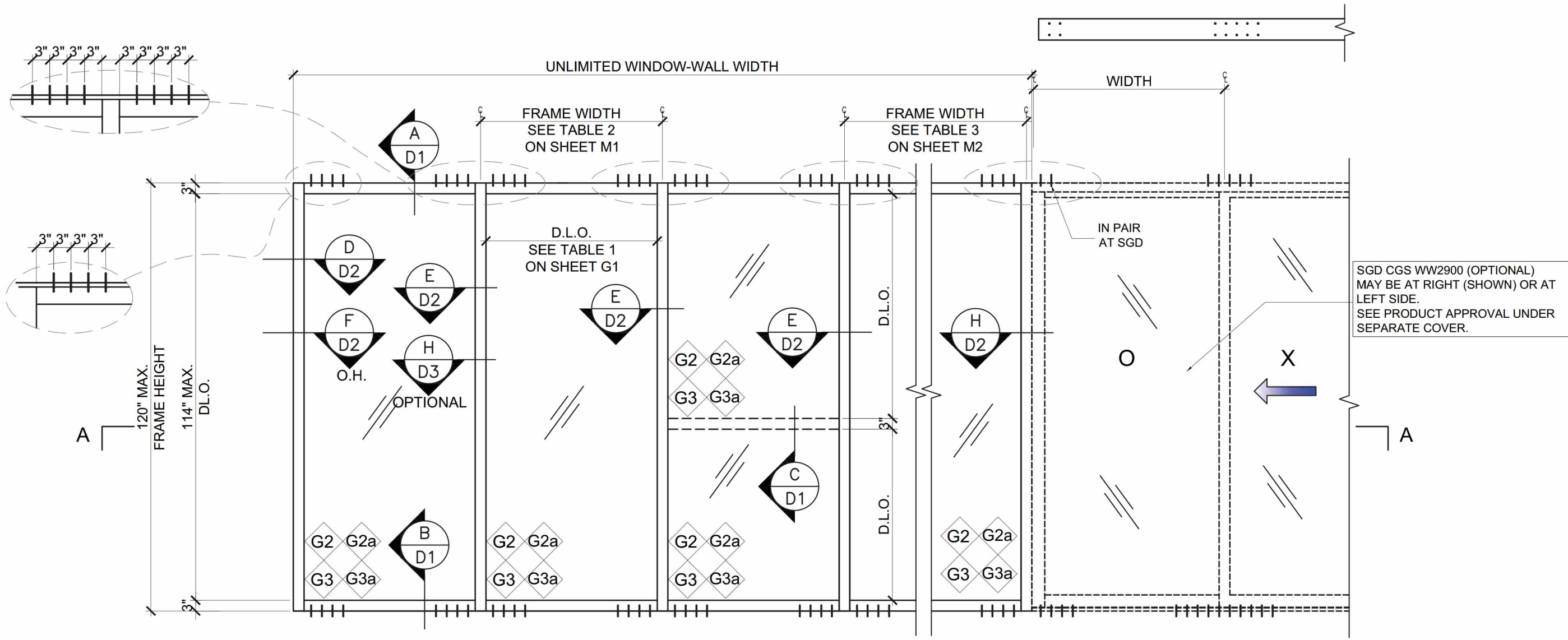

**TYPICAL EXTERIOR ELEVATION**  
UNREINFORCED

MAX ALLOWABLE DESIGN LOAD  
(REFER TO TABLES 1, 2, 3 & 4)  
+ 126.0 PSF  
- 126.0 PSF

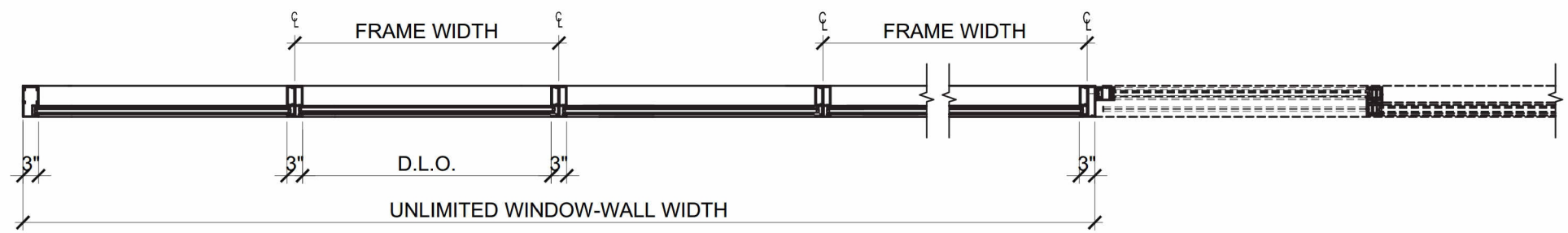

**SECTION A-A**

SERIES 3900WW  
FL #18312.2

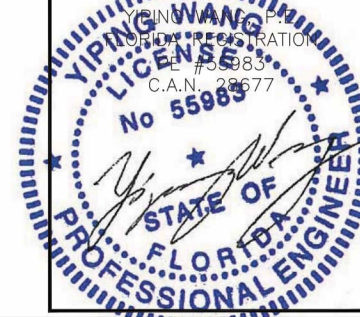

NO	DATE	REVISIONS	DESCRIPTION

**MCY ENGINEERING, INC.**  
GLAZING CONSULTANTS

8501 SW 124 Ave, Ste. 205A  
MIAMI, FL 33183  
P: 305.271.0117  
F: 305.279.6818  
www.MCYEngineering.com    MCY.Engineering@Att.net

SERIES 3900 WINDOW WALL - SMI

**CONTINENTAL GLASS SYSTEMS, LLC.**  
325 WEST 74 PLACE HIALEAH, FL 33014  
TEL (305) 231-1101 FAX (305) 231-1103

<b>E1</b>	
DATE	08/21/15
SCALE	AS SHOWN
DRAWN	T.G.
PROJECT	15-101
DRAWING NO.	AD15-58
2 OF 12	

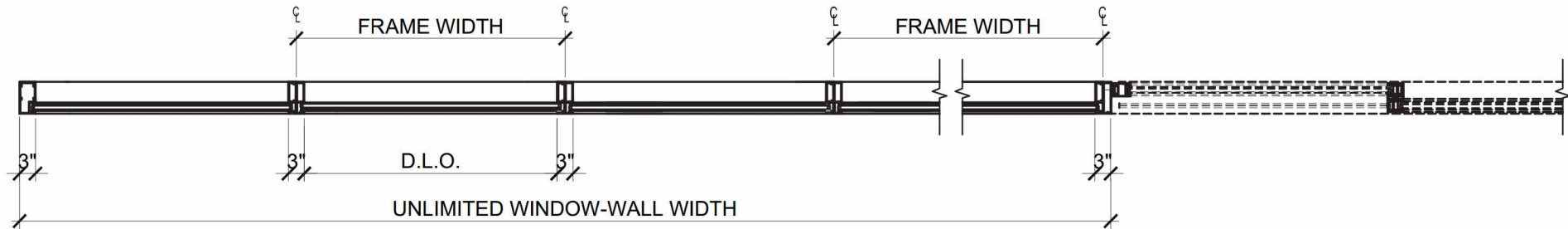
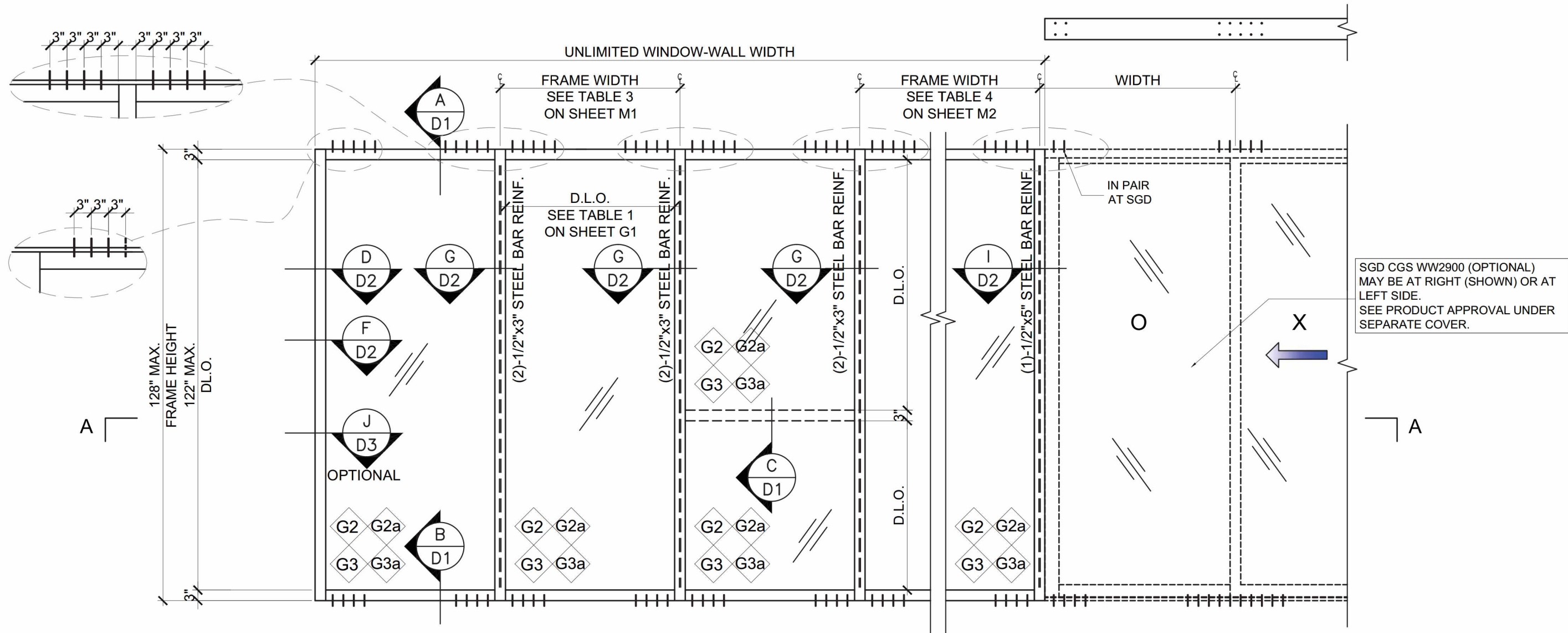

SERIES 3900WW

FL #18312.2

YIPING WANG  
PROFESSIONAL ENGINEER  
No 55983  
STATE OF FLORIDA

DATE	08/21/15
SCALE	AS SHOWN
DRAWN	T.G.
PROJECT	15-101
DRAWING NO.	AD15-58

NO	DATE	REVISIONS	DESCRIPTION

**MCY ENGINEERING, INC.**  
GLAZING CONSULTANTS

8501 SW 124 Ave, Ste. 205A  
MIAMI, FL 33183  
P: 305.271.0117  
F: 305.279.6818  
www.MCYEngineering.com    MCY.Engineering@Att.net

SERIES 3900 WINDOW WALL - SMI

**CONTINENTAL GLASS SYSTEMS, LLC.**  
325 WEST 74 PLACE HIALEAH, FL 33014  
TEL (305) 231-1101 FAX (305) 231-1103

<b>E2</b>	
DATE	08/21/15
SCALE	AS SHOWN
DRAWN	T.G.
PROJECT	15-101
DRAWING NO.	AD15-58

TABLE 1:

GLASS CAPACITY			
D.L.O. WIDTH	D.L.O. HEIGHT	TYPE G2&G2A	TYPE G3&G3A
(IN.)	(IN.)	(PSF)	(PSF)
45	78	141	141
51		141	141
57		141	141
63		141	141
69		141	141
45	84	141	141
51		141	141
57		141	141
63		141	141
69		141	141
45	90	141	141
51		141	141
57		141	141
63		141	141
69		141	141
45	96	141	141
51		141	141
57		141	141
60		141	141
69		141	141
45	102	141	141
51		141	141
54		141	141
57		141	141
69		141	141
45	108	141	141
48		141	141
51		141	141
54		141	141
69		141	141
42	114	141	141
45		141	141
48		141	141
51		141	141
69		141	141
42	120	141	141
45		141	141
48		141	141
51		141	141
69		141	141
42	124	141	141
45		141	141
48		141	141
51		141	141
69		141	141

NOTE:  
GLASS COMPLIES WITH ASTM  
E1300-09 (3 SEC. GUSTS).

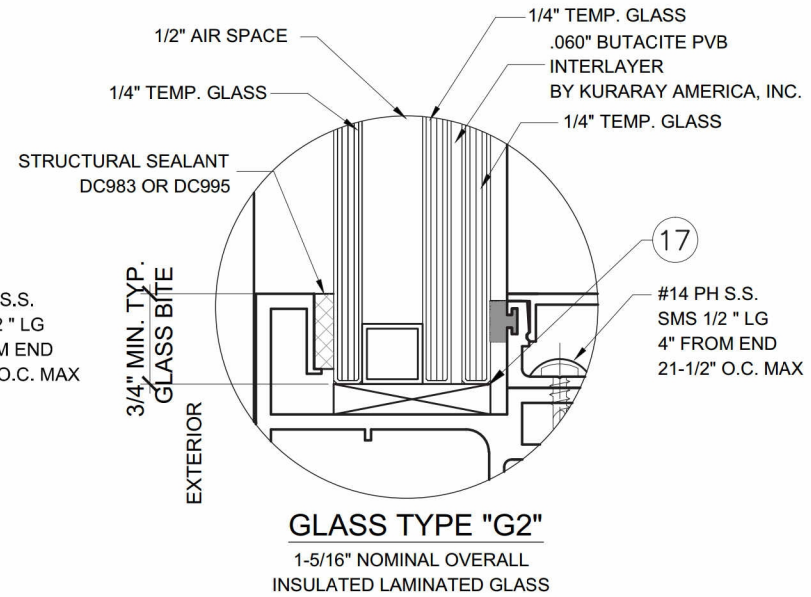
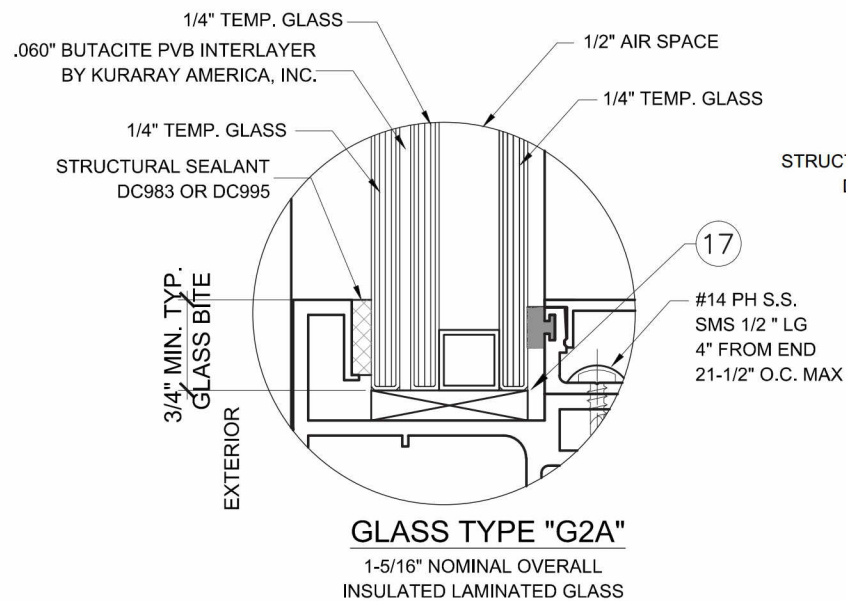
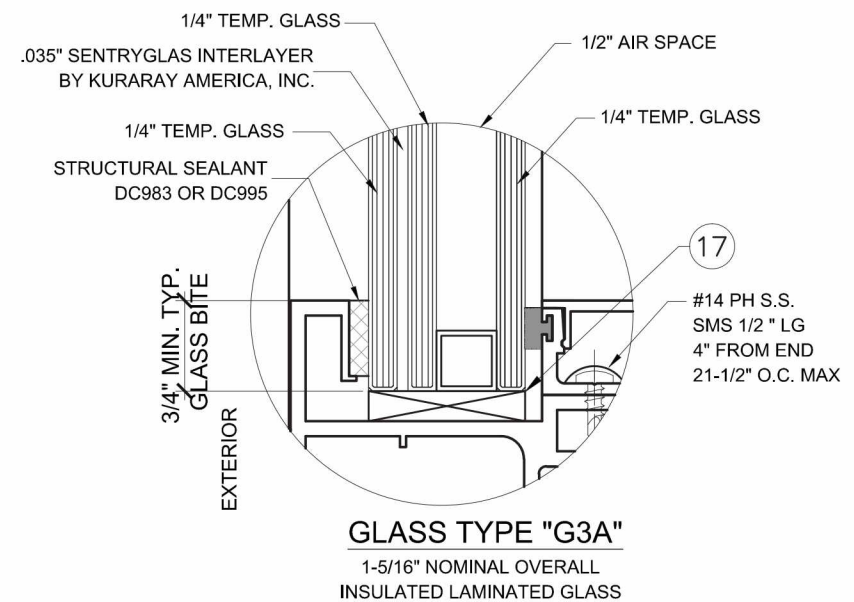
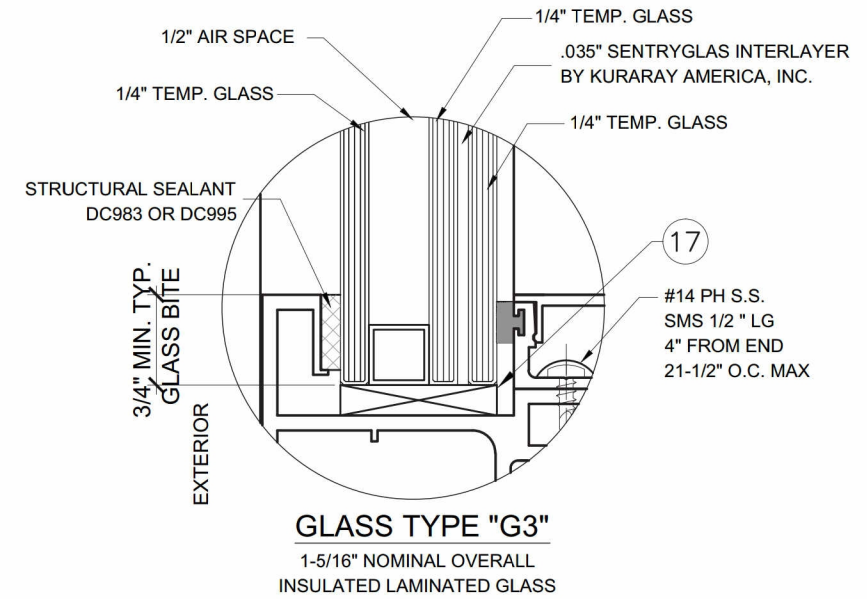
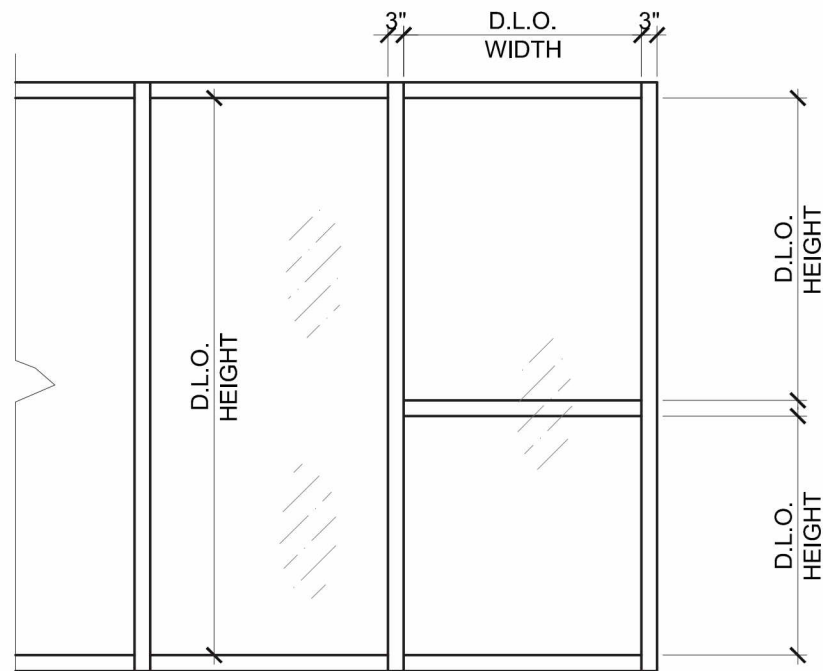

NO.	DATE	DESCRIPTION

**MCY ENGINEERING, INC.**  
GLAZING CONSULTANTS

8501 SW 124 Ave. Ste. 205A  
MIAMI, FL 33183

P: 305.271.0117  
F: 305.279.6818

www.MCYEngineering.com  
MCY.Engineering@Att.net

SERIES 3900 WINDOW WALL - SMI

**CONTINENTAL GLASS SYSTEMS, LLC.**  
325 WEST 74 PLACE HIALEAH, FL 33014  
TEL (305) 231-1101 FAX (305) 231-1103

SERIES 3900WW  
FL #18312.2

YIPING WANG, P.E.  
FLORIDA REGISTRATION  
No 55983

STATE OF FLORIDA  
PROFESSIONAL ENGINEER

G1	
DATE	08/21/15
SCALE	AS SHOWN
DRAWN BY	T.G.
PROJECT	15-101
DRAWING NO.	15-58
4 OF 12	

TABLE 2:

SINGLE SPAN MULLION LOAD CAPACITY – PSF						
MULLION TYPE		M1, M1A		J1	M2, M2A	
WINDOW PANEL		W/O HORIZ.	W/HORIZ.	W/O OR W/HORIZ.	W/O HORIZ.	W/HORIZ.
WIDTH W(IN)	HEIGHT H(IN)	EXT.(+) INT.(-)	EXT.(+) INT.(-)	EXT.(+) INT.(-)	EXT.(+) INT.(-)	EXT.(+) INT.(-)
48	84	126.0	126.0	141.0	141.0	141.0
54		126.0	126.0	141.0	141.0	141.0
60		126.0	126.0	141.0	141.0	141.0
66		126.0	126.0	141.0	141.0	141.0
72		126.0	126.0	141.0	141.0	141.0
48	90	126.0	126.0	141.0	141.0	141.0
54		126.0	126.0	141.0	141.0	141.0
60		126.0	126.0	141.0	141.0	141.0
66		126.0	126.0	141.0	141.0	141.0
72		–	–	141.0	141.0	141.0
48	96	126.0	126.0	141.0	141.0	141.0
54		126.0	126.0	141.0	141.0	141.0
60		126.0	126.0	141.0	141.0	141.0
66		–	–	141.0	141.0	141.0
48	102	126.0	126.0	141.0	141.0	141.0
54		126.0	126.0	141.0	141.0	141.0
60		126.0	126.0	141.0	141.0	141.0
63		–	–	141.0	141.0	141.0
66		–	–	141.0	141.0	141.0
48	108	126.0	126.0	141.0	141.0	141.0
54		126.0	126.0	141.0	141.0	141.0
57		126.0	126.0	141.0	141.0	141.0
60		–	–	141.0	141.0	141.0
48	114	126.0	126.0	141.0	141.0	141.0
51		126.0	126.0	141.0	141.0	141.0
54		126.0	126.0	141.0	141.0	141.0
57		–	–	141.0	141.0	141.0
45	120	126.0	126.0	141.0	141.0	141.0
48		126.0	126.0	141.0	141.0	141.0
51		126.0	124.4	141.0	141.0	141.0
54		–	–	141.0	141.0	141.0
45	126	–	–	141.0	141.0	141.0
48		–	–	141.0	141.0	141.0
51		–	–	141.0	141.0	141.0
45	128	–	–	141.0	141.0	141.0
48		–	–	141.0	141.0	141.0
51		–	–	141.0	141.0	140.0

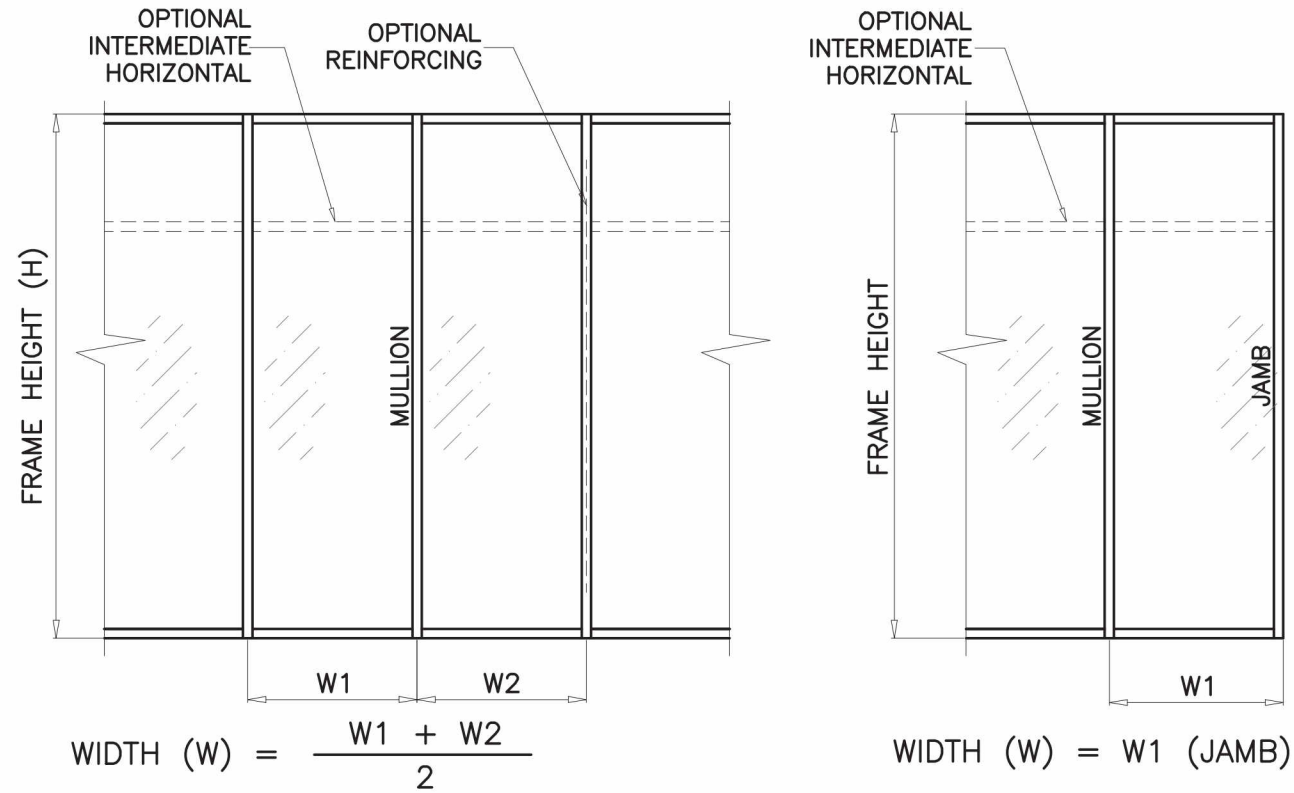

J1	Ix IN <sup>4</sup>	Sx IN <sup>3</sup>
3900-04	14.328	4.384
M1	Ix IN <sup>4</sup>	Sx IN <sup>3</sup>
3900-06	7.258	2.255
3900-05	10.582	3.510
TOTAL	17.840	5.542
M2	Ix IN <sup>4</sup>	Sx IN <sup>3</sup>
3900-06	7.258	2.255
3900-05	10.582	3.510
(2)ST-1	6.525	–
TOTAL	24.365	IN ALUM.
M1A	Ix IN <sup>4</sup>	Sx IN <sup>3</sup>
3900-24	12.645	3.042
3900-25	8.548	2.229
TOTAL	21.193	5.271
M2A	Ix IN <sup>4</sup>	Sx IN <sup>3</sup>
3900-24	12.645	3.042
3900-25	8.548	2.229
(2)ST-1	6.525	–
TOTAL	27.718	IN ALUM.

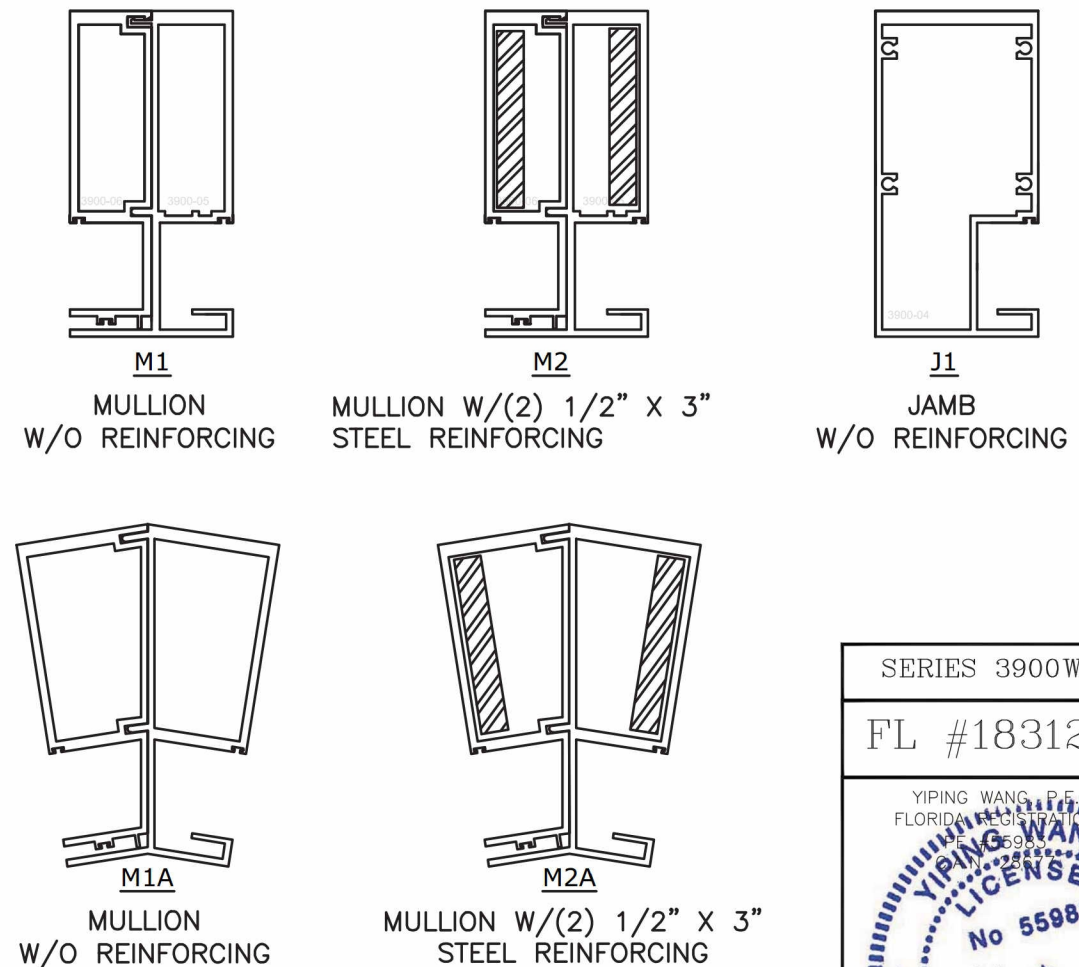

SERIES 3900WW  
FL #18312.2

YIPING WANG, P.E.  
FLORIDA REGISTRATION NO. 55983  
YIPING WANG  
LICENSE  
No 55983  
STATE OF FLORIDA  
PROFESSIONAL ENGINEER

NO.	DATE	DESCRIPTION

**MCY ENGINEERING, INC.**  
GLAZING CONSULTANTS  
8501 SW 124 Ave. Ste. 205A  
MIAMI, FL 33183  
P: 305.271.0117  
F: 305.279.6818  
www.MCYEngineering.com  
MCY.Engineering@Att.net

SERIES 3900 WINDOW WALL - SMI  
**CONTINENTAL GLASS SYSTEMS, LLC.**  
325 WEST 74 PLACE HIALEAH, FL 33014  
TEL (305) 231-1101 FAX (305) 231-1103

M1	
DATE	08/21/15
SCALE	AS SHOWN
DRAWN BY	T.G.
PROJECT	15-101
DRAWING NO.	15-58
5 OF 12	

TABLE 3:

SINGLE SPAN W/SGD MULLION LOAD CAPACITY – PSF						
MULLION TYPE		M3		J1	M4	
WINDOW PANEL		W/O HORIZ.	W/HORIZ.	W/O OR W/HORIZ.	W/O HORIZ.	W/HORIZ.
WIDTH W(IN)	HEIGHT H(IN)	EXT.(+) INT.(-)	EXT.(+) INT.(-)	EXT.(+) INT.(-)	EXT.(+) INT.(-)	EXT.(+) INT.(-)
48	84	140.0	140.0	141.0	140.0	140.0
54		140.0	140.0	141.0	140.0	140.0
60		140.0	140.0	141.0	140.0	140.0
66		140.0	140.0	141.0	140.0	140.0
72		140.0	140.0	141.0	140.0	140.0
48	90	140.0	140.0	141.0	140.0	140.0
54		140.0	140.0	141.0	140.0	140.0
60		140.0	140.0	141.0	140.0	140.0
66		140.0	140.0	141.0	140.0	140.0
72		140.0	140.0	141.0	140.0	140.0
48	96	140.0	140.0	141.0	140.0	140.0
54		140.0	140.0	141.0	140.0	140.0
60		140.0	140.0	141.0	140.0	140.0
66		140.0	140.0	141.0	140.0	140.0
72		140.0	140.0	141.0	140.0	140.0
48	102	140.0	140.0	141.0	140.0	140.0
54		140.0	140.0	141.0	140.0	140.0
60		140.0	140.0	141.0	140.0	140.0
63		140.0	140.0	141.0	140.0	140.0
72		140.0	140.0	141.0	140.0	140.0
48	108	140.0	140.0	141.0	140.0	140.0
54		140.0	140.0	141.0	140.0	140.0
57		140.0	140.0	141.0	140.0	140.0
60		140.0	140.0	141.0	140.0	140.0
72		140.0	140.0	141.0	140.0	140.0
48	114	140.0	140.0	141.0	140.0	140.0
51		140.0	140.0	141.0	140.0	140.0
54		140.0	140.0	141.0	140.0	140.0
57		140.0	137.5	141.0	140.0	140.0
72		140.0	140.0	141.0	140.0	140.0
45	120	140.0	140.0	141.0	140.0	140.0
48		140.0	137.5	141.0	140.0	140.0
51		134.9	129.9	141.0	140.0	140.0
54		128.6	123.3	141.0	140.0	140.0
72		140.0	140.0	141.0	140.0	140.0
45	126	129.2	125.9	141.0	140.0	140.0
48		122.0	118.4	141.0	140.0	140.0
51		115.7	111.9	141.0	140.0	140.0
54		109.4	105.1	141.0	140.0	140.0
72		140.0	140.0	141.0	140.0	140.0
45	130	117.3	114.4	140.0	140.0	140.0
48		110.7	107.6	140.0	140.0	140.0
51		104.9	101.6	140.0	138.8	135.2
54		99.1	95.8	140.0	135.0	131.4
72		140.0	140.0	141.0	140.0	140.0

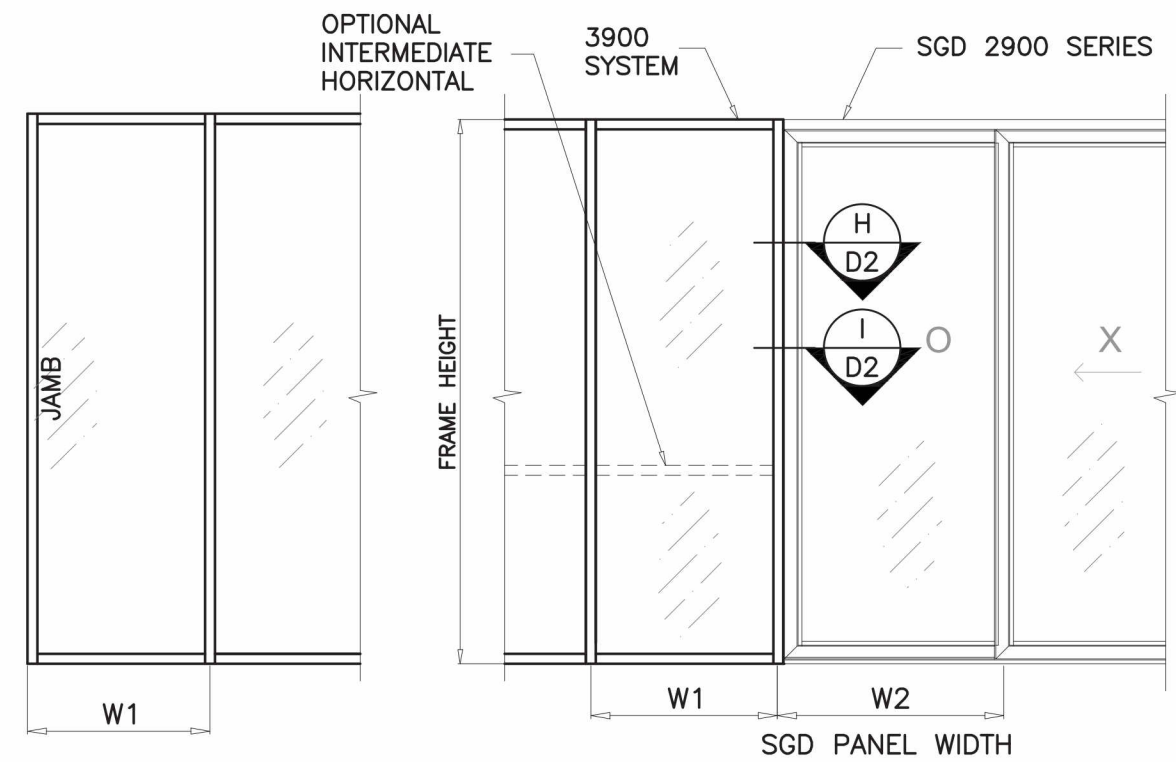

WIDTH (W) = W1 (JAMB)                      WIDTH (W) =  $\frac{W1 + W2}{2}$

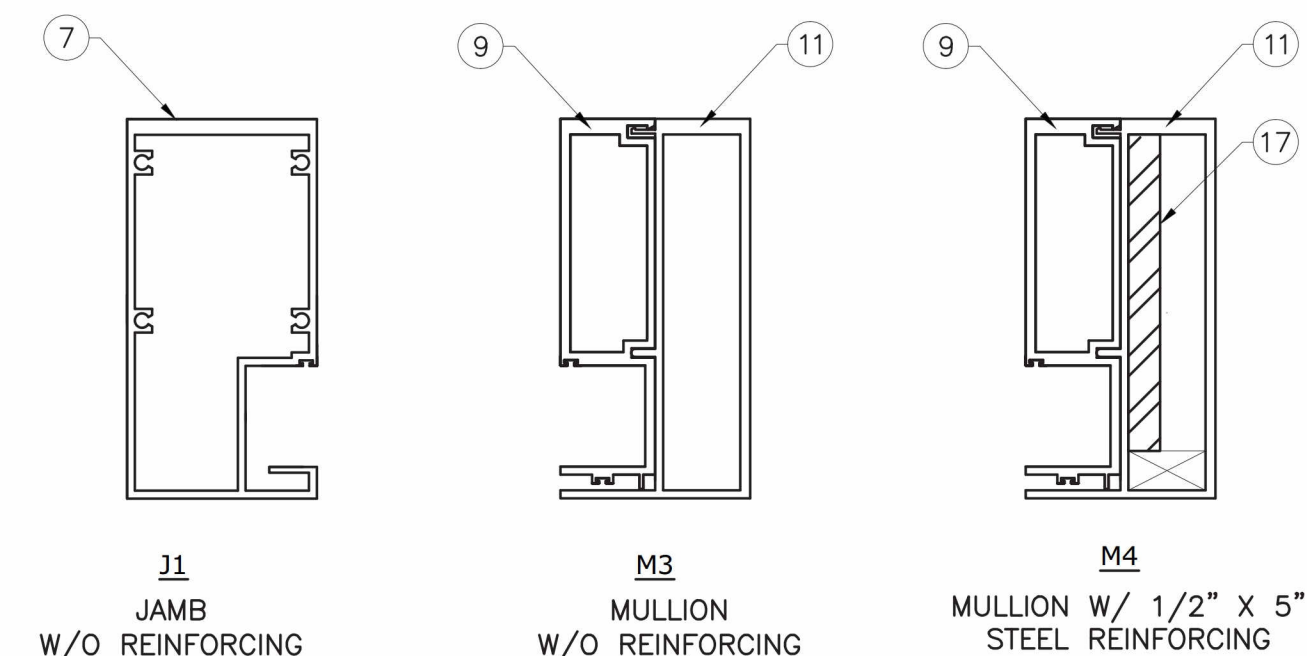

M3	Ix IN <sup>4</sup>	Sx IN <sup>3</sup>
3900-06	7.258	2.255
3900-09	10.716	3.529
TOTAL	17.974	5.583

M4	Ix IN <sup>4</sup>	Sx IN <sup>3</sup>
3900-06	7.258	2.255
3900-09	10.716	3.529
ST-2	15.104	-
TOTAL	33.078	IN ALUM.

SERIES 3900WW  
FL #18312.2

YIPING WANG  
REGISTERED PROFESSIONAL ENGINEER  
No 55983  
C.A.N. 28677

REVISIONS	DESCRIPTION
NO. DATE	

**MCY ENGINEERING, INC.**  
GLAZING CONSULTANTS

8501 SW 124 Ave. Ste. 205A  
MIAMI, FL 33183

P: 305.271.0117  
F: 305.279.6818

www.MCYEngineering.com    MCY.Engineering@Att.net

SERIES 3900 WINDOW WALL - SMI

**CONTINENTAL GLASS SYSTEMS, LLC.**  
325 WEST 74 PLACE HIALEAH, FL 33014  
TEL (305) 231-1101 FAX (305) 231-1103

M2	
DATE	08/21/15
SCALE	AS SHOWN
DRAWN	T.G.
PROJECT	15-101
DRAWING NO.	AD15-58
6 OF 12	

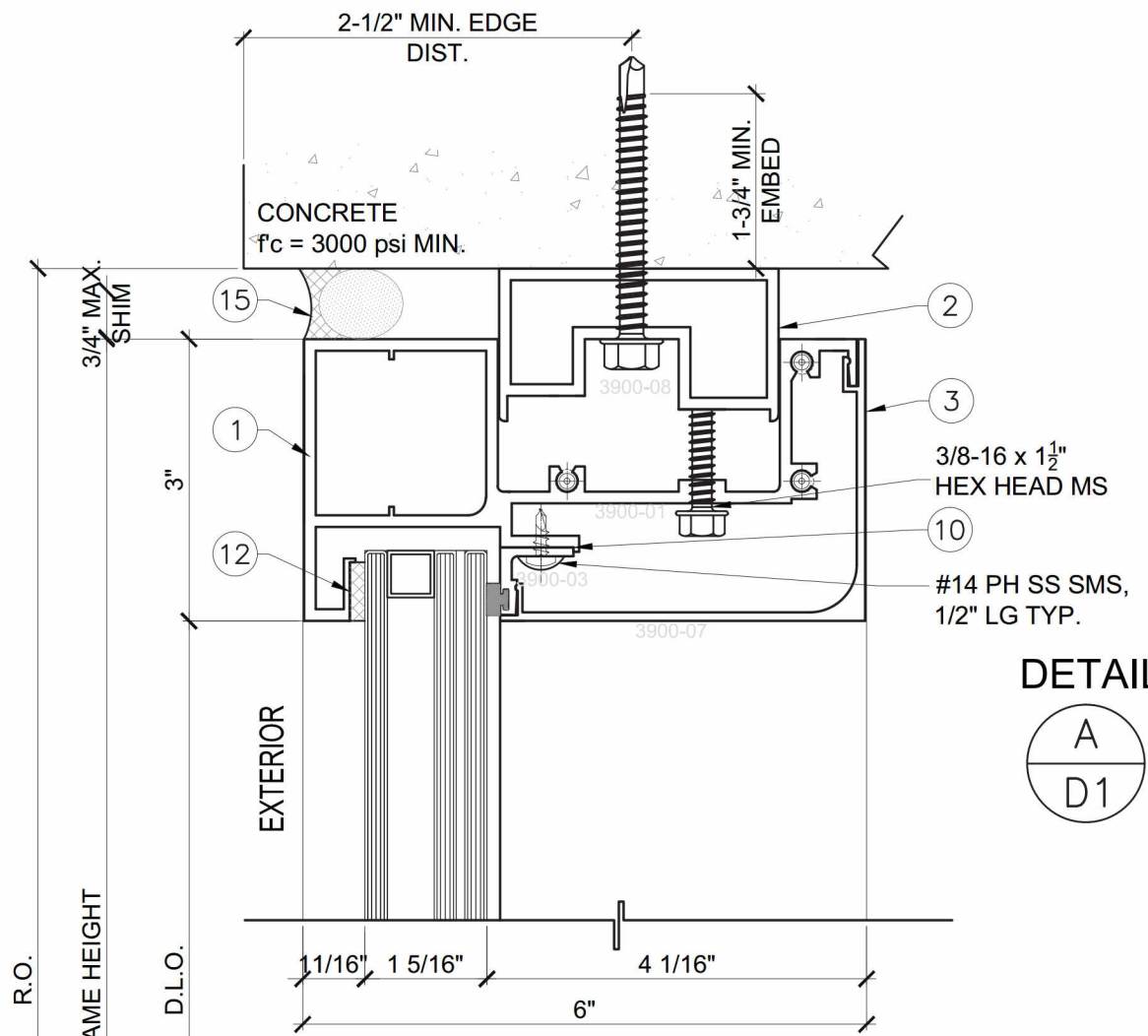

DETAIL  
A  
D1

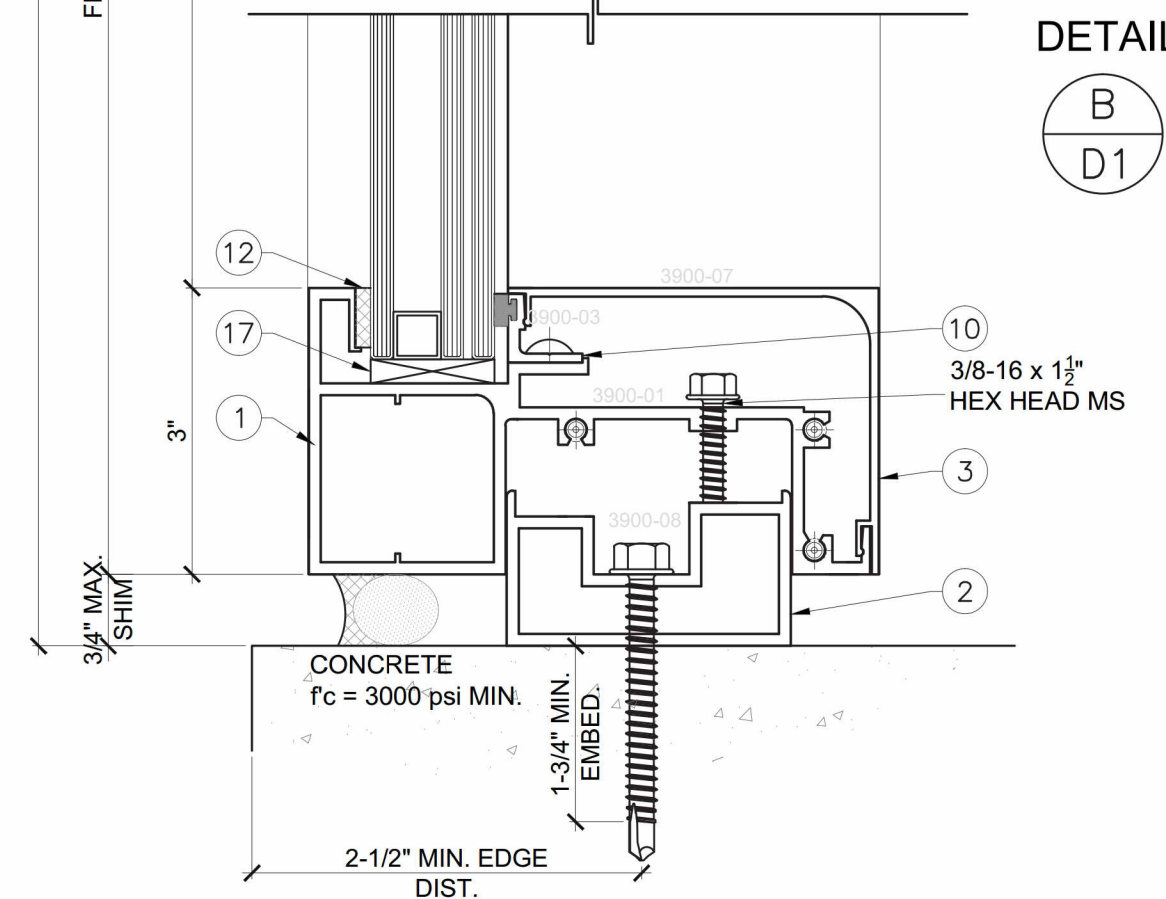

DETAIL  
B  
D1

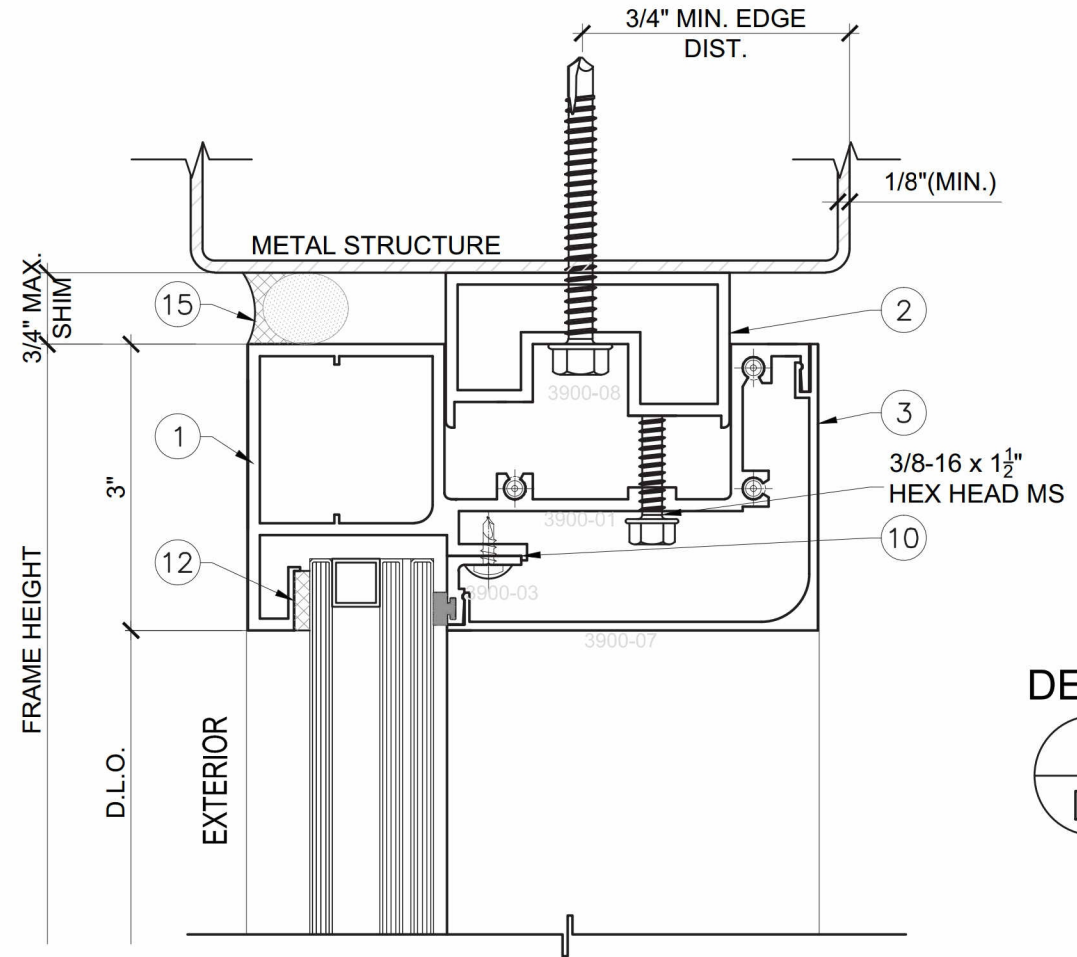

DETAIL  
A  
D1

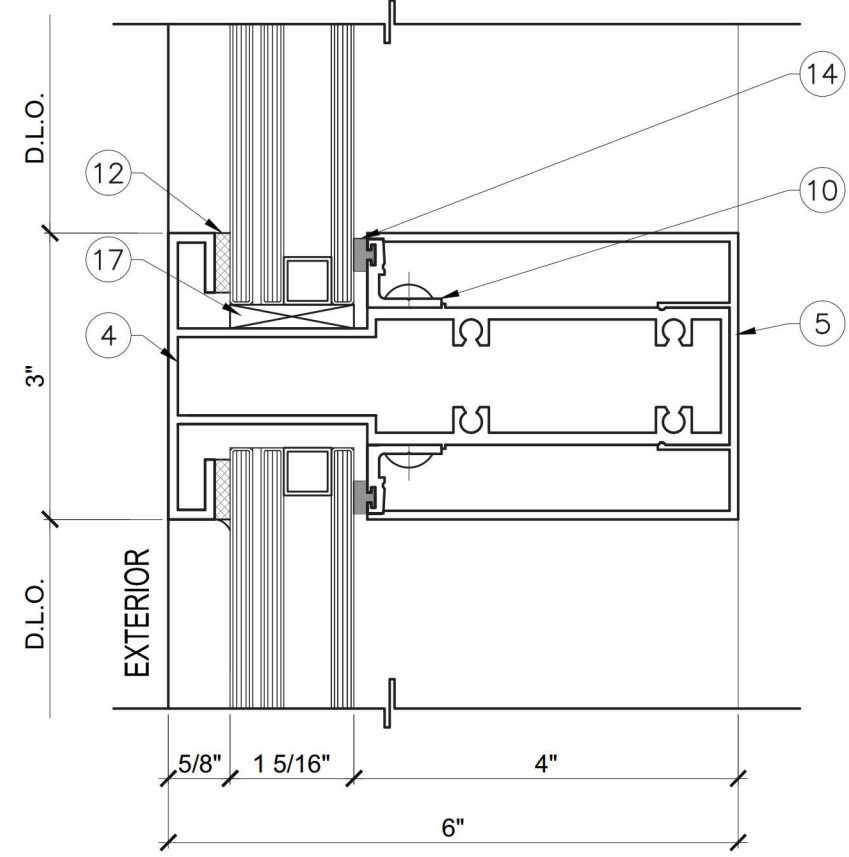

DETAIL  
C  
D1

SERIES 3900WW

FL #18312.2

YIPING WANG  
PROFESSIONAL ENGINEER  
No 55983  
STATE OF FLORIDA

NO	DATE	REVISIONS	DESCRIPTION

**MCY ENGINEERING, INC.**  
GLAZING CONSULTANTS

8501 SW 124 Ave, Ste. 205A  
MIAMI, FL 33183  
P: 305.271.0117  
F: 305.279.6818  
www.MCYEngineering.com  
MCY.Engineering@Att.net

SERIES 3900 WINDOW WALL - SMI

**CONTINENTAL GLASS SYSTEMS, LLC.**  
325 WEST 74 PLACE HIALEAH, FL 33014  
TEL (305) 231-1101 FAX (305) 231-1103

D1
DATE 08/21/15
SCALE AS SHOWN
DRAWN T.G.
PROJECT 15-101
DRAWING NO. AD15-58
7 OF 12

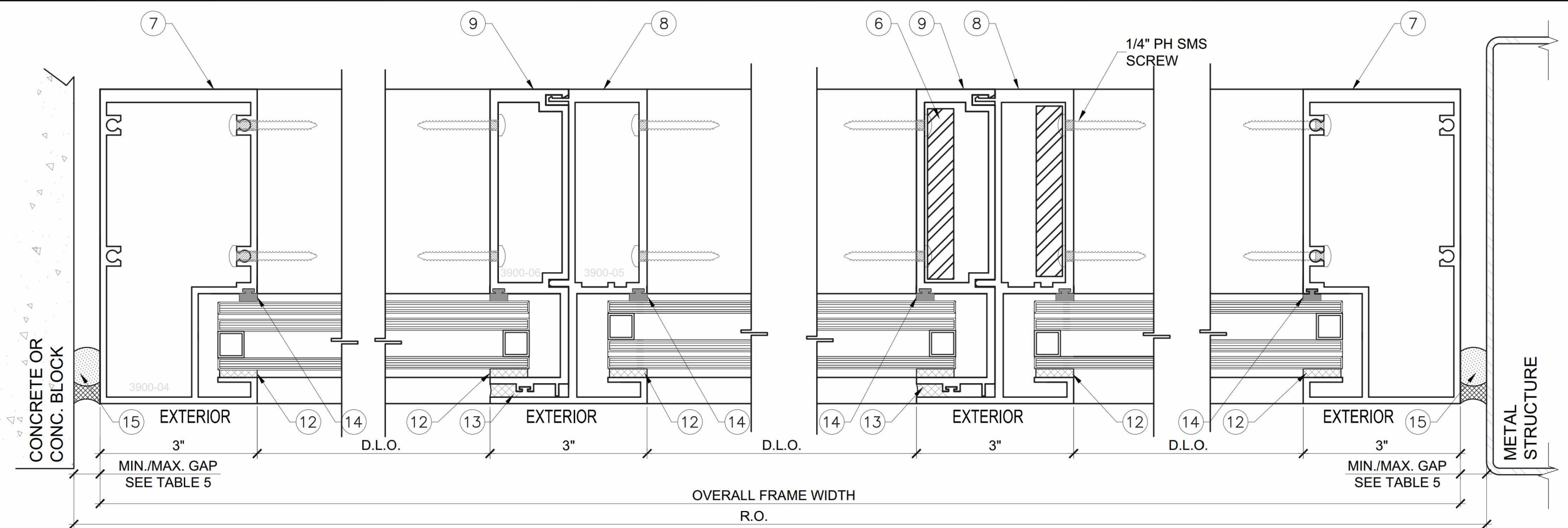

OVERALL FRAME WIDTH  
R.O.

DETAIL  $\frac{D}{D2}$

DETAIL  $\frac{E}{D2}$

DETAIL  $\frac{G}{D2}$

DETAIL  $\frac{F}{D2}$

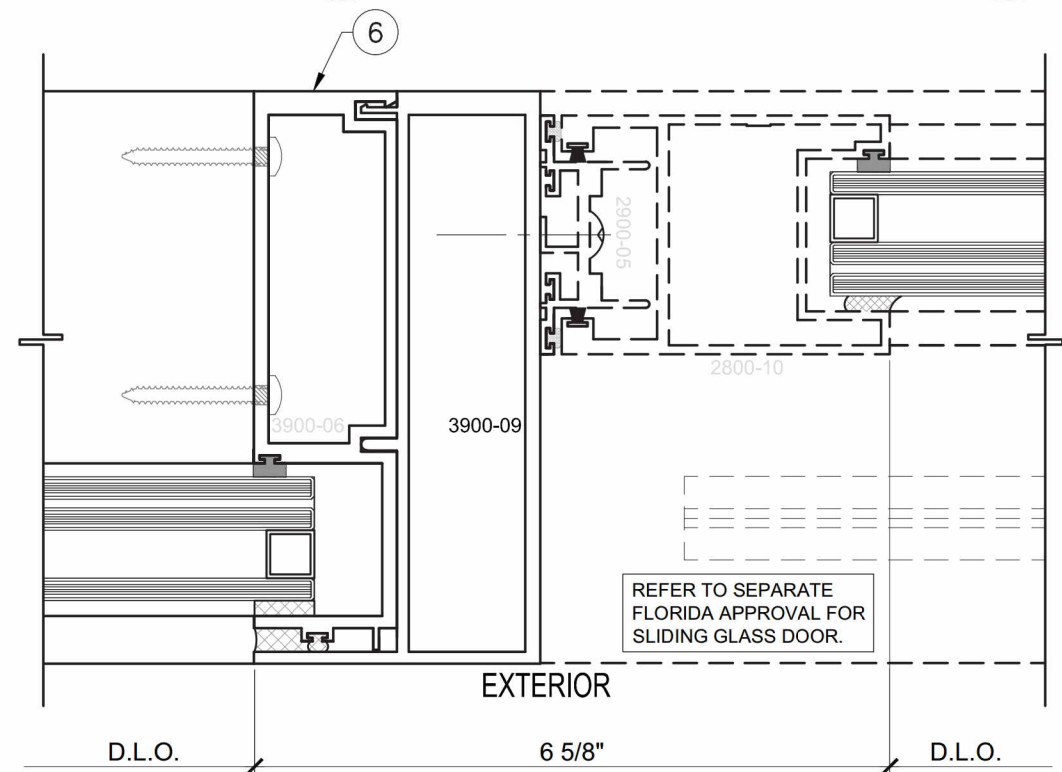

REFER TO SEPARATE FLORIDA APPROVAL FOR SLIDING GLASS DOOR.

DETAIL  $\frac{H}{D2}$

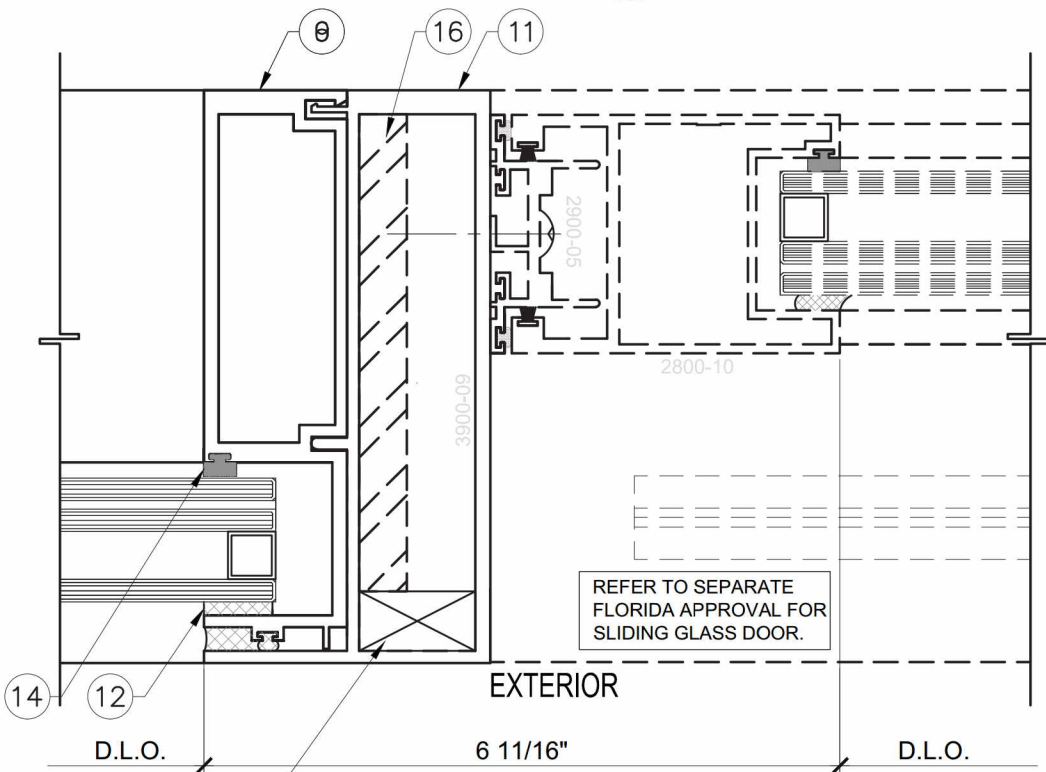

REFER TO SEPARATE FLORIDA APPROVAL FOR SLIDING GLASS DOOR.

SHIM TIGHT FIT INSIDE OF MULLION, FULL LENGTH

DETAIL  $\frac{I}{D2}$

TABLE 5:

MAX. FRAME HEIGHT	JAMB GAP	
	MIN.	MAX.
90"	5/16"	1-1/2"
96"	5/16"	1-1/2"
102"	3/8"	1-1/2"
108"	3/8"	1-1/2"
114"	3/8"	1-1/2"
120"	1/2"	1-1/2"
126"	1/2"	1-1/2"
130"	1/2"	1-1/2"

SERIES 3900WW  
FL #18312.2

YIPING WANG  
PROFESSIONAL ENGINEER  
No. 55983  
C.A.N. 28677

NO.	DATE	REVISIONS	DESCRIPTION

**MCY ENGINEERING, INC.**  
GLAZING CONSULTANTS  
8501 SW 124 Ave. Ste. 205A  
MIAMI, FL 33183  
P: 305.271.0117  
F: 305.279.6818  
www.MCYEngineering.com  
MCY.Engineering@Att.net

SERIES 3900 WINDOW WALL - SMI  
**CONTINENTAL GLASS SYSTEMS, LLC.**  
325 WEST 74 PLACE HIALEAH, FL 33014  
TEL (305) 231-1101 FAX (305) 231-1103

D2	
DATE	08/21/15
SCALE	AS SHOWN
DRAWN	T.G.
PROJECT	15-101
DRAWING NO.	AD15-58
8 OF 12	



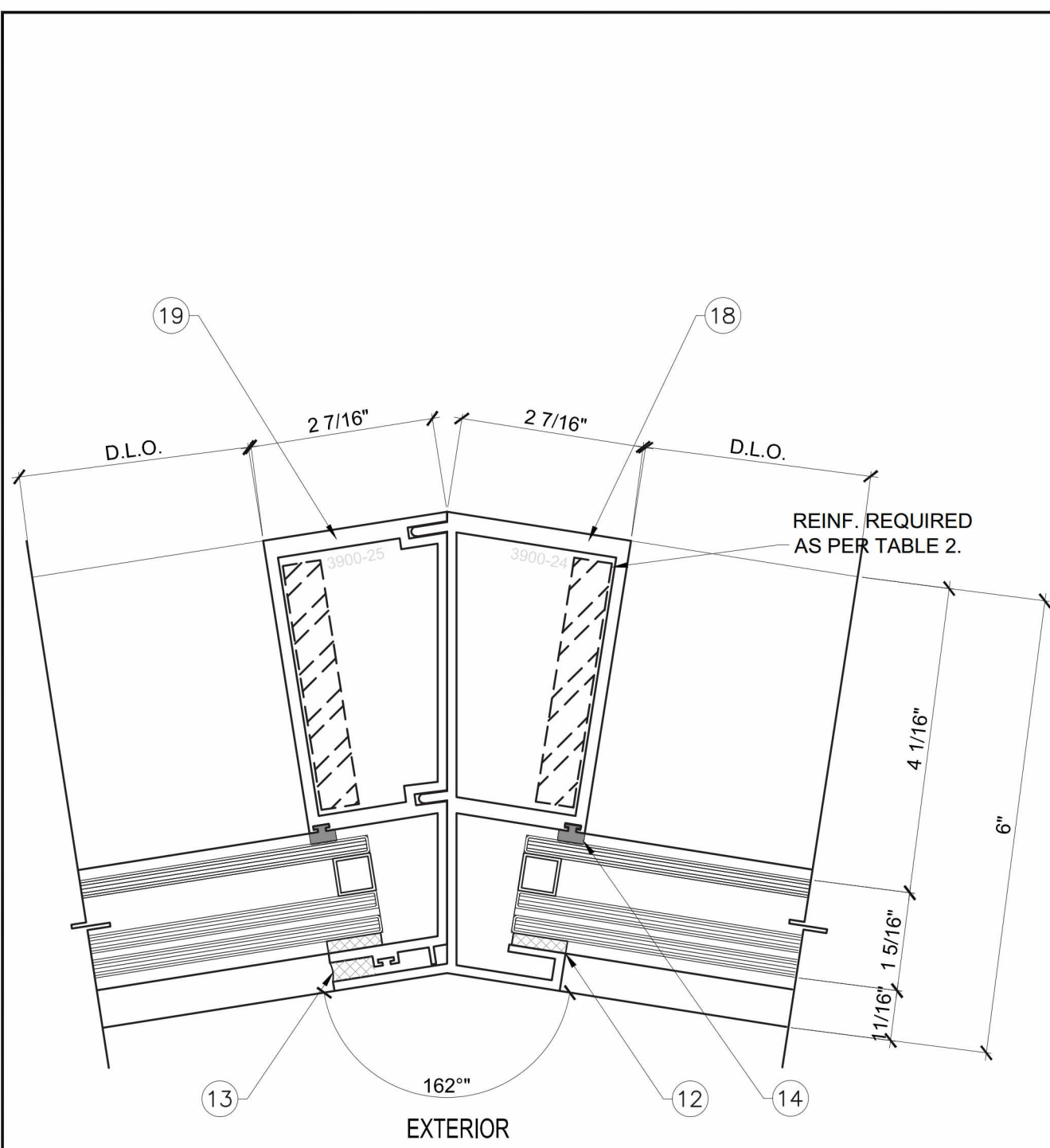

DETAIL  $\frac{H}{D3}$

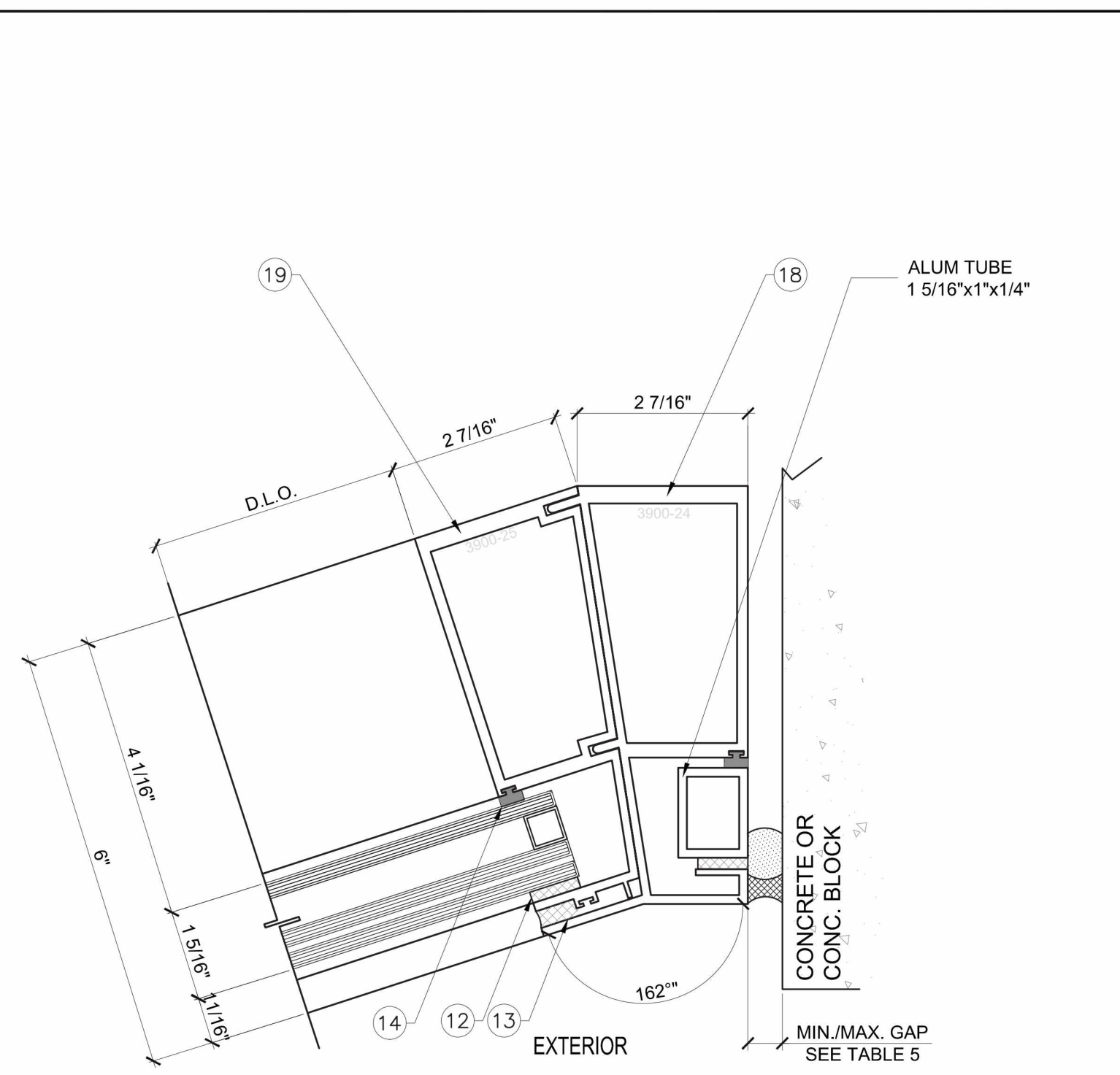

DETAIL  $\frac{J}{D3}$

SERIES 3900WW  
FL #18312.2

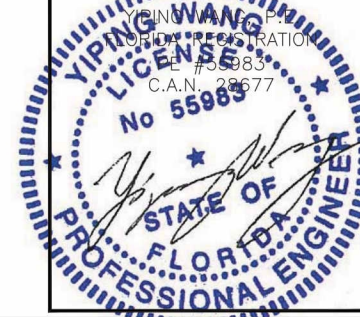

NO.	DATE	REVISIONS	DESCRIPTION

**MCY ENGINEERING, INC.**  
GLAZING CONSULTANTS  
8501 SW 124 Ave, Ste. 205A  
MIAMI, FL 33183  
P: 305.271.0117  
F: 305.279.6818  
www.MCYEngineering.com  
MCY.Engineering@Att.net

SERIES 3900 WINDOW WALL - SMI  
**CONTINENTAL GLASS SYSTEMS, LLC.**  
325 WEST 74 PLACE HIALEAH, FL 33014  
TEL (305) 231-1101 FAX (305) 231-1103

D3	
DATE	08/21/15
SCALE	AS SHOWN
DRAWN	T.G.
PROJECT	15-101
DRAWING NO.	AD15-58
9 OF 12	

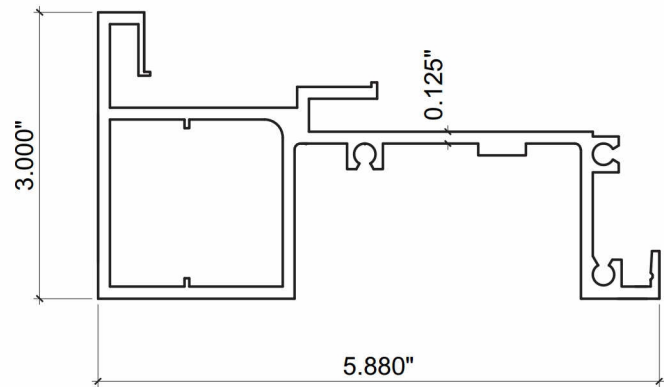

1 HEAD & SILL  
3900-01 6005-T5

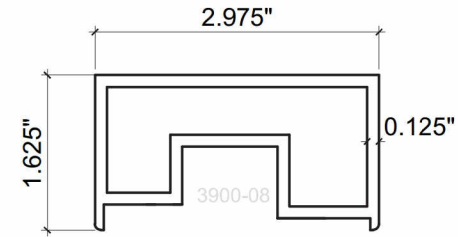

2 ADJUSTER  
3900-08 6005-T5

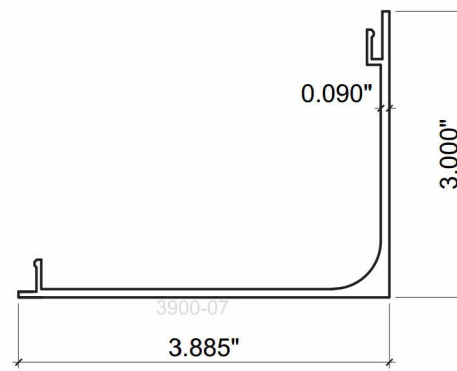

3 COVER  
3900-07 6063-T6

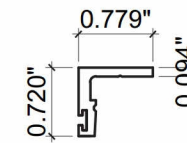

10 GLAZING BEAD  
3900-03 6005-T5

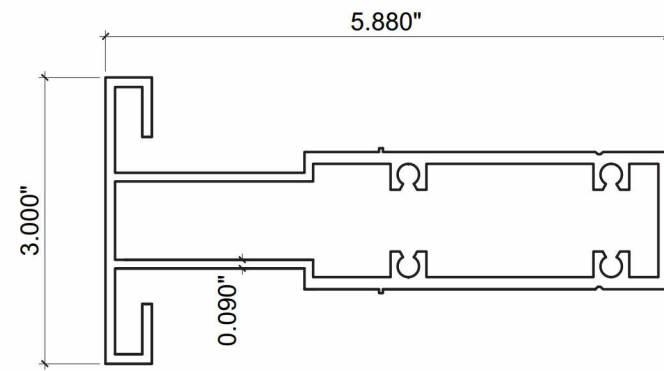

4 INTERMEDIATE  
3900-12 6005-T5

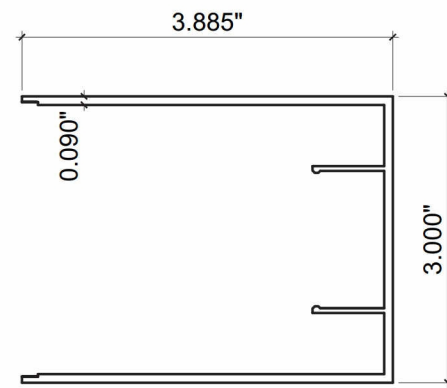

5 COVER  
3900-13 6005-T5

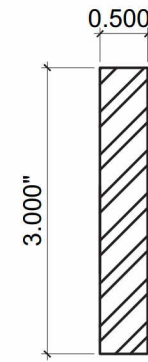

6 STEEL BAR REINFORCEMENT  
3" X 1/2"

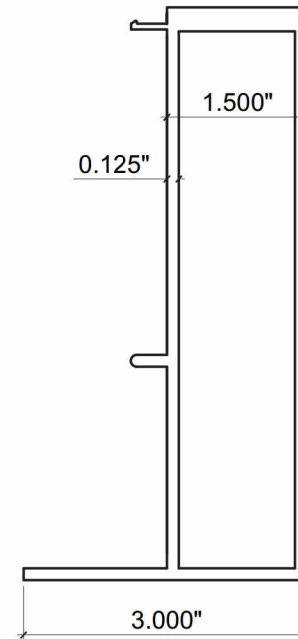

11 MALE MULLION  
3900-09 6005-T5

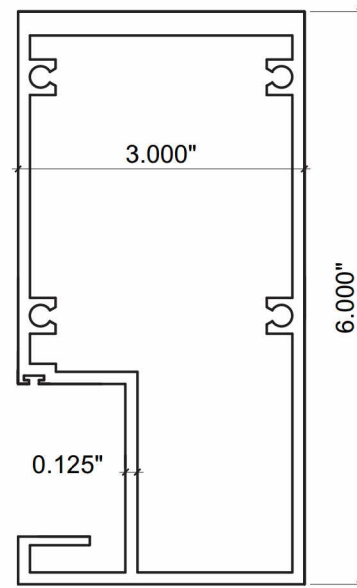

7 JAMB  
3900-04 6005-T5

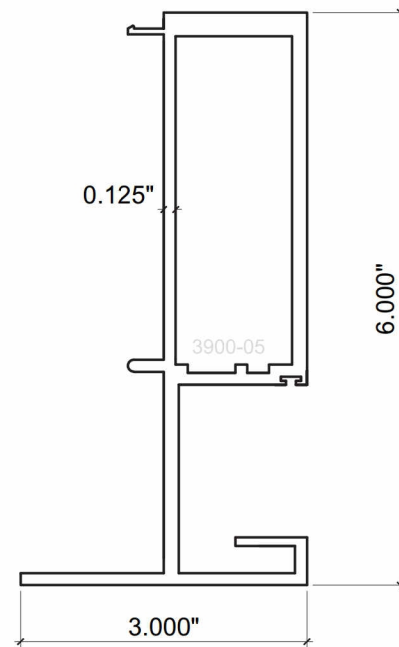

8 MALE MULLION  
3900-05 6005-T5

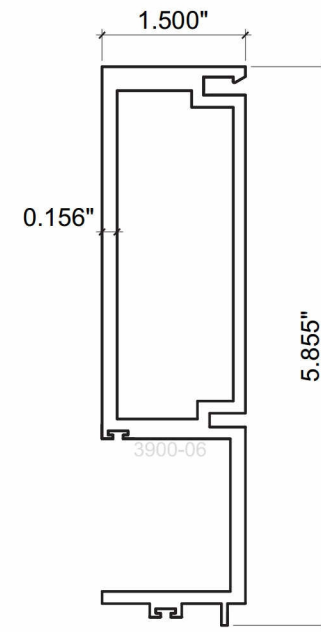

9 FEMALE MULLION  
3900-06 6005-T5

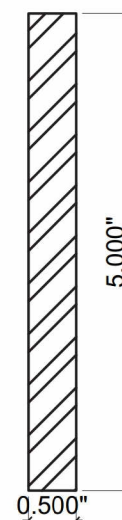

16 STEEL REINF.  
1/2" X 5" A36 MIN.

SERIES 3900WW  
FL #18312.2

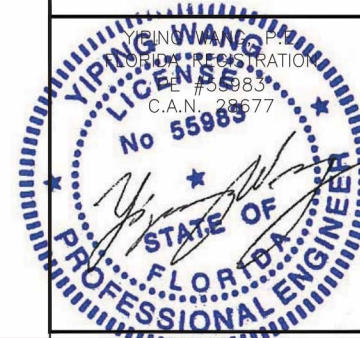

NO.	DATE	REVISIONS	DESCRIPTION

**MCY ENGINEERING, INC.**  
GLAZING CONSULTANTS  
8501 SW 124 Ave. Ste. 205A  
MIAMI, FL 33183  
P: 305.271.0117  
F: 305.279.6818  
www.MCYEngineering.com  
MCY.Engineering@Att.net

SERIES 3900 WINDOW WALL - SMI  
**CONTINENTAL GLASS SYSTEMS, LLC.**  
325 WEST 74 PLACE HIALEAH, FL 33014  
TEL (305) 231-1101 FAX (305) 231-1103

EXTRUSIONS	
DATE	08/21/15
SCALE	AS SHOWN
DRAWN	T.G.
PROJECT	15-101
DRAWING NO.	AD15-58
10 OF 12	

# BILL OF MATERIALS

ITEM #	PROFILE	DESCRIPTION	MATERIAL	MANUFACTURER/REMARKS
1	3900-01	HEAD/SILL	ALUM. 6005-T5	-
2	3900-08	ADJUSTER	ALUM. 6005-T5	-
3	3900-07	COVER	ALUM. 6063-T6	-
4	3900-12	INTERMEDIATE	ALUM. 6005-T5	-
5	3900-13	COVER	ALUM. 6063-T6	-
6	-	1/2" X 3" STEEL BAR REINFORCEMENT	STEEL	A36 MIN.
7	3900-04	JAMB	ALUM. 6005-T5	-
8	3900-05	MALE MULLION	ALUM. 6005-T5	-
9	3900-06	FEMALE MULLION	ALUM. 6005-T5	-
10	3900-03	GLAZING BEAD	ALUM. 6005-T5	-
11	3900-09	MALE MULLION	ALUM. 6005-T5	-
12	-	DOW CORNING STRUCTURAL SEALANT DC983 OR DC795	SILICONE	DOW CORNING
13	-	DOW CORNING DC795 CONT. PERIMETER SEALANT	SILICONE	DOW CORNING
14	-	GASKET	POLYPROPYLENE / SANTOPRENE	ULTRA FAB
15	-	DOW CORNING DC790 CONT. PERIMETER SEALANT AND BACKER ROD	SILICONE	DOW CORNING
16	-	1/2" X 5" STEEL BAR REINFORCEMENT	STEEL	A36 MIN.
17	-	1/4 " X 3/4 " X 4 " SETTING BLOCK	SILICONE	-
18	3900-24	MALE MULLION	ALUM. 6005-T5	-
19	3900-25	FEMALE MULLION	ALUM. 6005-T5	-

REVISIONS	DESCRIPTION
NO.	DATE

**MCY ENGINEERING, INC.**  
GLAZING CONSULTANTS

8501 SW 124 Ave. Ste. 205A  
MIAMI, FL 33183  
P: 305.271.0117  
F: 305.279.6818  
www.MCYEngineering.com    MCY.Engineering@Att.net

SERIES 3900 WINDOW WALL - SMI

**CONTINENTAL GLASS SYSTEMS, LLC.**  
325 WEST 74 PLACE HIALEAH, FL 33014  
TEL (305) 231-1101    FAX (305) 231-1103

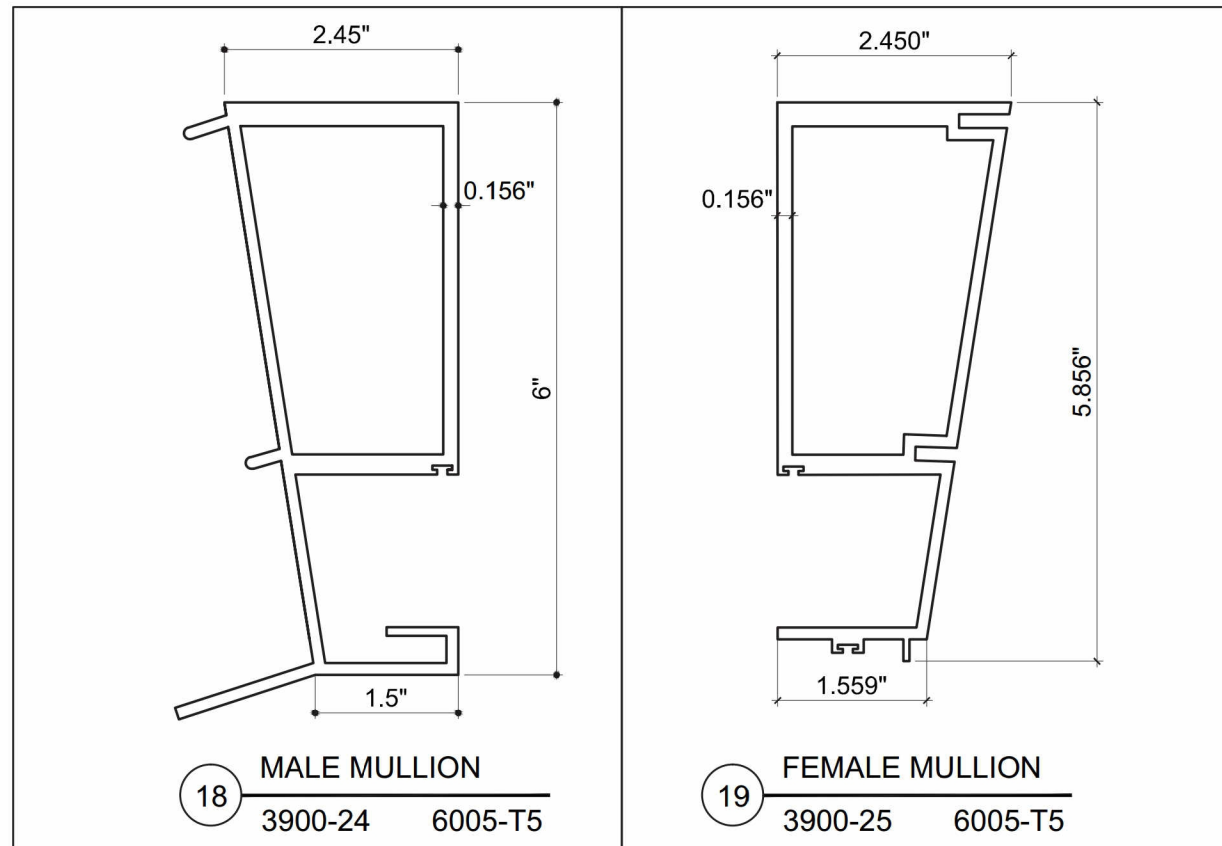

SERIES 3900WW  
FL #18312.2

**YIPING WANG**  
PROFESSIONAL ENGINEER  
FLORIDA  
No 55983  
C.A.N. 28677

**BOM**

DATE	08/21/15
SCALE	AS SHOWN
DRAWN	T.G.
PROJECT	15-101
DRAWING NO.	AD15-58

11 OF 12

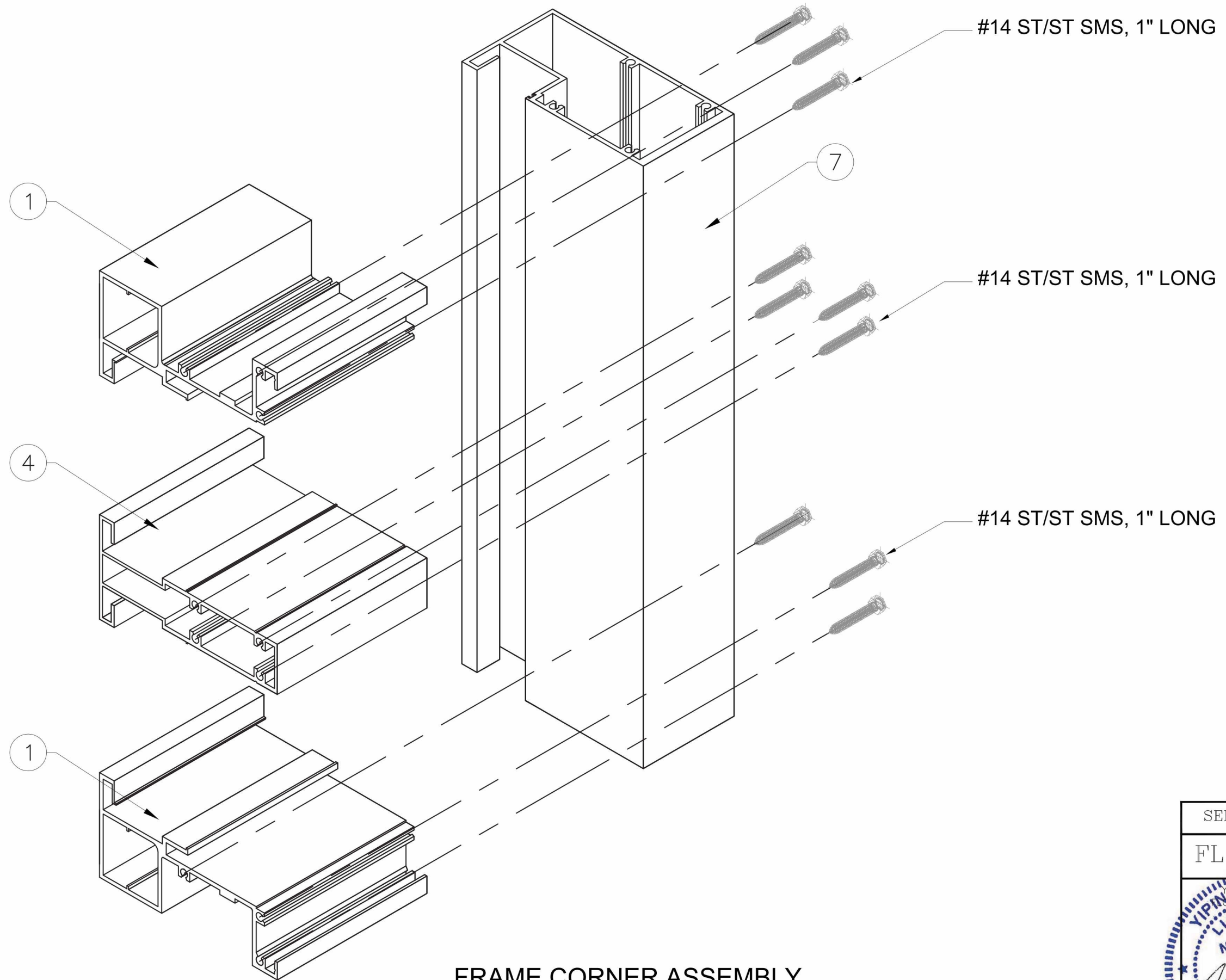

**FRAME CORNER ASSEMBLY  
TOP AND BOTTOM**

SERIES 3900WW  
FL #18312.2

YIPING WANG  
PROFESSIONAL ENGINEER  
FLORIDA  
No 55983  
C.A.N. 28677

NO	DATE	REVISIONS	DESCRIPTION

**MCY ENGINEERING, INC.**  
GLAZING CONSULTANTS

8501 SW 124 Ave. Ste. 205A  
MIAMI, FL 33183

P: 305.271.0117  
F: 305.279.6818

www.MCYEngineering.com    MCY.Engineering@Att.net

SERIES 3900 WINDOW WALL - SMI

**CONTINENTAL GLASS SYSTEMS, LLC.**  
325 WEST 74 PLACE HIALEAH, FL 33014  
TEL (305) 231-1101    FAX (305) 231-1103

ISO	
DATE	08/21/15
SCALE	AS SHOWN
DRAWN	T.G.
PROJECT	15-101
DRAWING NO.	AD15-58
12 OF 12	